

IF IN DOUBT ASK  
DO NOT SCALE FROM THIS DRAWING  
CHECK DRAWING ON RECEIPT AND IMMEDIATELY REPORT ANY DISCREPANCIES TO ARCHITECT  
VERIFY ALL DIMENSIONS/LEVELS ON SITE PRIOR TO CONSTRUCTION

THE CONTENTS OF THIS DRAWING ARE THE COPYRIGHT AND SHALL NOT BE REPRODUCED WITHOUT THE WRITTEN PERMISSION OF THE ARCHITECT

**EXISTING DRAINAGE** All existing drainage where being retained within curtilage of building to be rodded clean and tested. Any leaks etc to be repaired.

**NEW DRAINAGE**

**Foul Drains** 100mm Super-Sleeve vitrified Clayware pipes and fittings surrounded with concrete where under building. Provide flexible joints immediately outside building. Pea shingle bed and surround where used externally.

Inspection chambers 215mm Class B Engineering brick or cast into r.c. slab to Engineers detail. Supra-steel or equal double seal locking type covers and frames internally. Supra-steel covers and frames externally to suit concrete block paving.

**Surface Water Drains** 100mm and 150mm Super-Sleeve vitrified Clayware pipes and fittings on 100mm pea shingle bed and surround. Surface water drains under building and parking area to be surrounded with 150mm concrete.

R.W. Shoes - Hepworth access pipe ref 69 with ref 200 raising pieces (225mm high) and alloy lid and frame set in concrete surround.

**S/W Drains Cont.**

Paving gullies (PG) - Hepworth yard gully complete with bucket, rodding eye and stopper ref 196 - 195mm square & 100mm outlet surrounded with concrete. Hinged grating and frame ref 1009 set in situ. concrete surround min 100mm wide.

Yard gullies (YG) - Hepworth yard gully ref 196 - complete with bucket, rodding eye and stopper - 285mm wide with 150mm dia outlet. Surrounded with min 150mm concrete.

Straight bar gully grating and frame BS Grade B Hepworth ref GR.325 set in min 150mm concrete surround including forming dishings to match precast concrete channel.

Soakaways - S1 & S2  
1800mm internal diameter  
1200mm deep below lowest inlet pipe invert constructed of 225mm solid concrete blocks laid honey-comb - (150mm min bearing) on 600 x 225 concrete foundation.  
150mm concrete cover slab reinforced with 2 layers A142 steel mesh.  
Grade B rect. manhole cover and frame in parking area and med. duty cover and frame in planting area.  
225 Class B engineering brickwork raising courses - min 225 high  
Surround soakaways with min 225mm (75-150 gauge) selected clean hardcore.

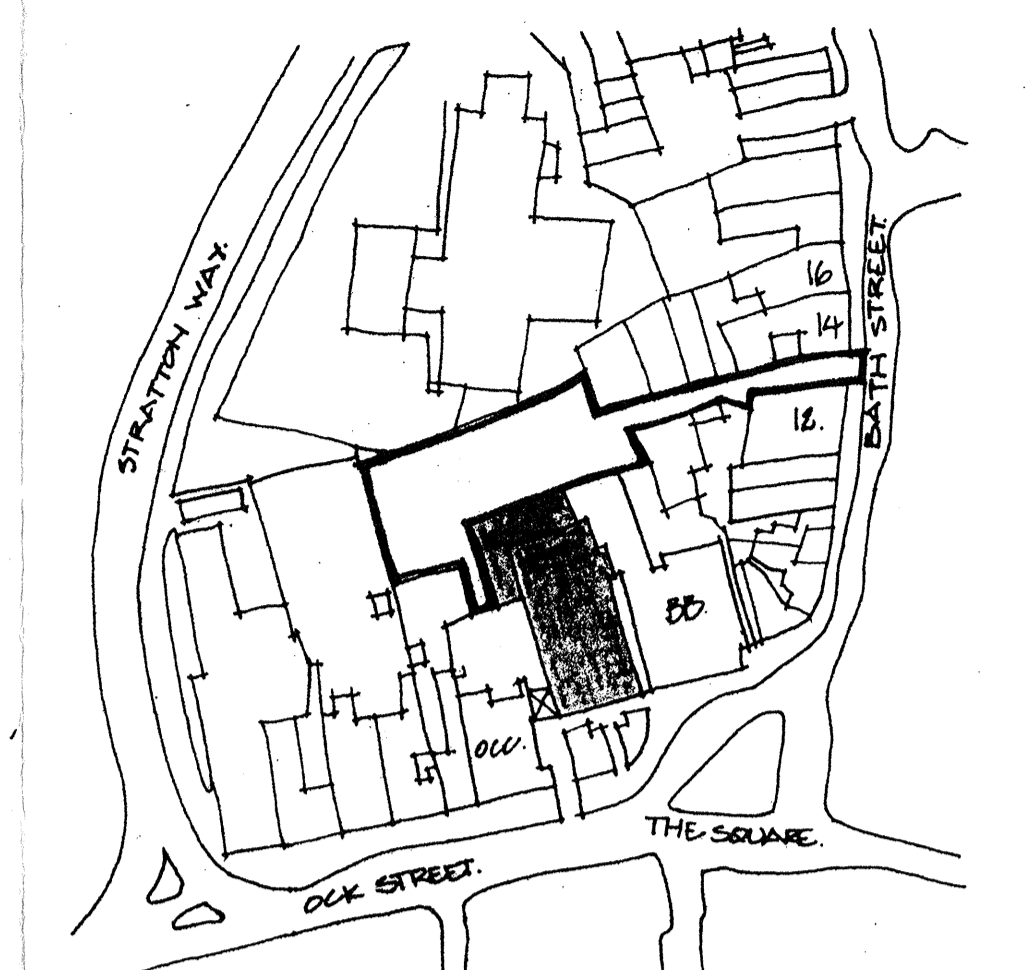

LOCATION PLAN, scale 1:1250

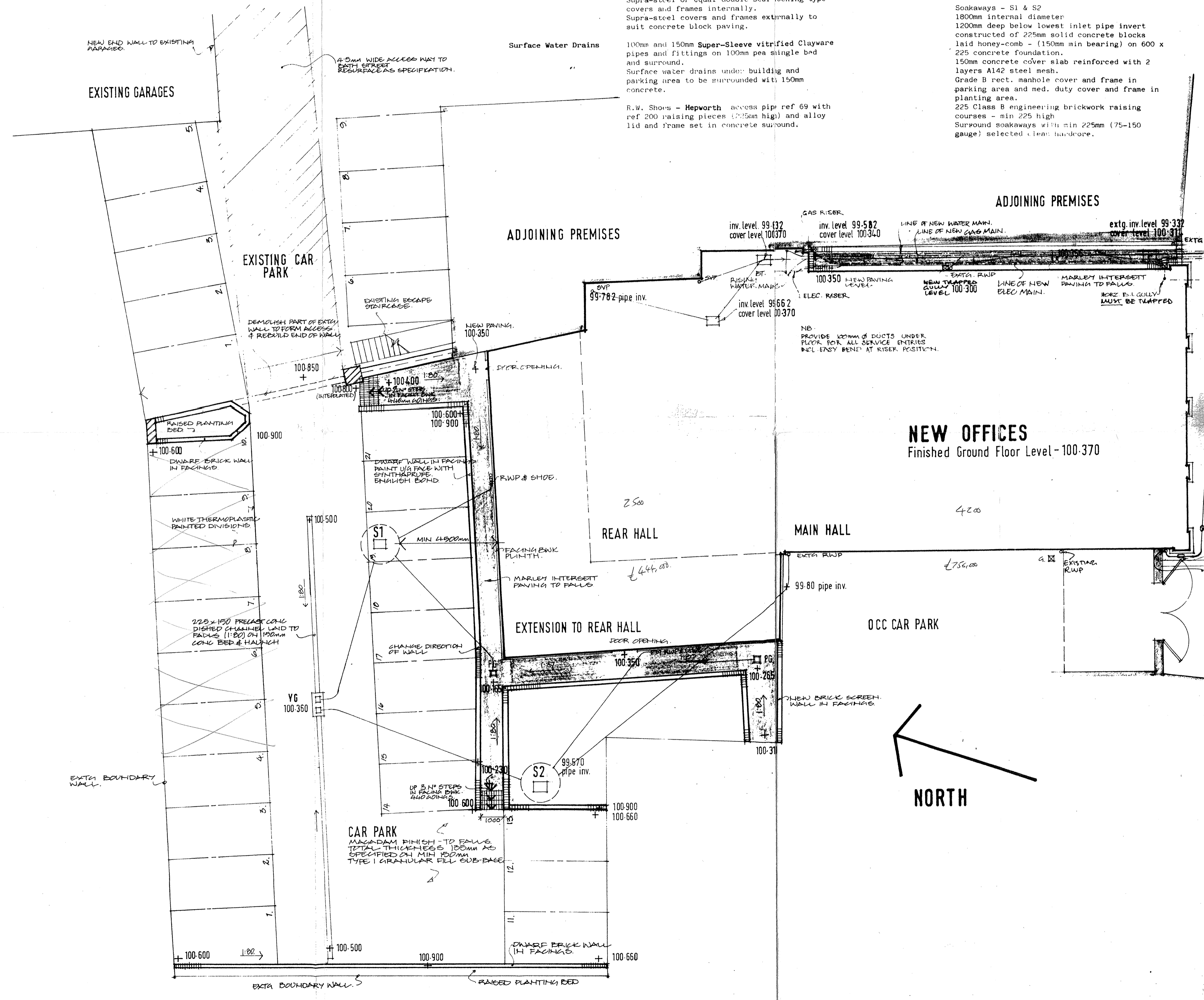

**AS BUILT RECORD DRAWING**

project no.	2-1025	drawg. no.	101	rev.		drawing title	EXTERNAL WORKS AND LOCATION PLAN	drawn	BR	date	MAY 1987	
project/client	PULPIT HOUSE, THE SQUARE, ABINGDON.						scale	1:100 1:1250				

John Spratley & Partners Architects and Consultants

Abingdon 0236 22206